

# MEDICAL SUPPLY CABINETS



**30 YEARS' EXPERIENCE**

IN DESIGN AND IMPLEMENTATION OF STORAGE  
ROOMS AND CLINICAL AREAS





# PEGASUS MEDICAL

**Pegasus Medical** is the partner of leading healthcare organizations and hospitals in 5 continents.

Our clients recommend our products and solutions since we greatly **simplify healthcare materials** management with flexible and scalable solutions.

We provide **significant cost savings** and stand behind our methodology with **unmatched expertise and support.**

## AMONG OUR CUSTOMERS:

### PeaceHealth



4 Hospitals in Kanban, ranging from 100-500 racks

### US Naval Ships



USNS Mercy & Comfort, approximately 900 racks

### US Naval Hospitals



10 Facilities in Kanban, 2650 total racks

### Veterans Administration



Kanban and High-Density Storage, over 30 facilities with 7,000+ racks

### Penn Presbyterian Med Ctr



250 racks. Kanban & Color Coding

### NYC Health+Hospitals



4 Hospitals, Kanban, 2200+ racks.

# PLANNING & DESIGN

Using our internal capabilities and our 30 years' experience in design and implementation of storage rooms and clinical areas, we will **enhance your facility design process and provide you with dedicated cost-effective storage solutions** for each of the areas where disposables and medication need to be stored and dispatched.

By using AutoCad design blocks, Revit files and 3D drawings we can assist your equipment planner/architect during the design phase with full room layouts.

Our storage experts will work closely with your supply chain team and clinical staff to ensure the most cost effective and efficient design is created to meet your needs.



## OUR WORK PROCESS

### STEP 1

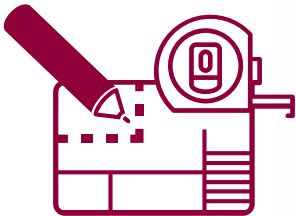

Perform a physical walk-through and assessment of all relevant storage locations & create CAD drawings for each storage location

OR

Receive facility CAD files from the architects

### STEP 2



Lay out the storage unit blocks in CAD drawings according to customer needs

### STEP 3

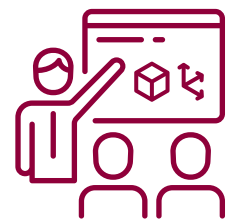

3D room illustrations to end users





**STEP 4**

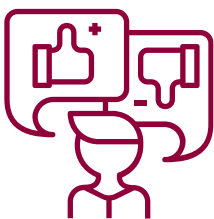

Customer feedback

**STEP 5**



Integration of  
customer feedback to  
the suggested design

**STEP 6**

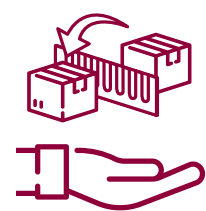

Performing TURN-KEY  
Kanban Installation

# CATH LAB INSTALLATION

USING A PROVEN TRACK RECORD, WE WILL ASSIST IN PLANNING YOUR STORAGE AREAS THROUGHOUT YOUR NEW OR RENOVATED FACILITY

## CAD DRAWINGS

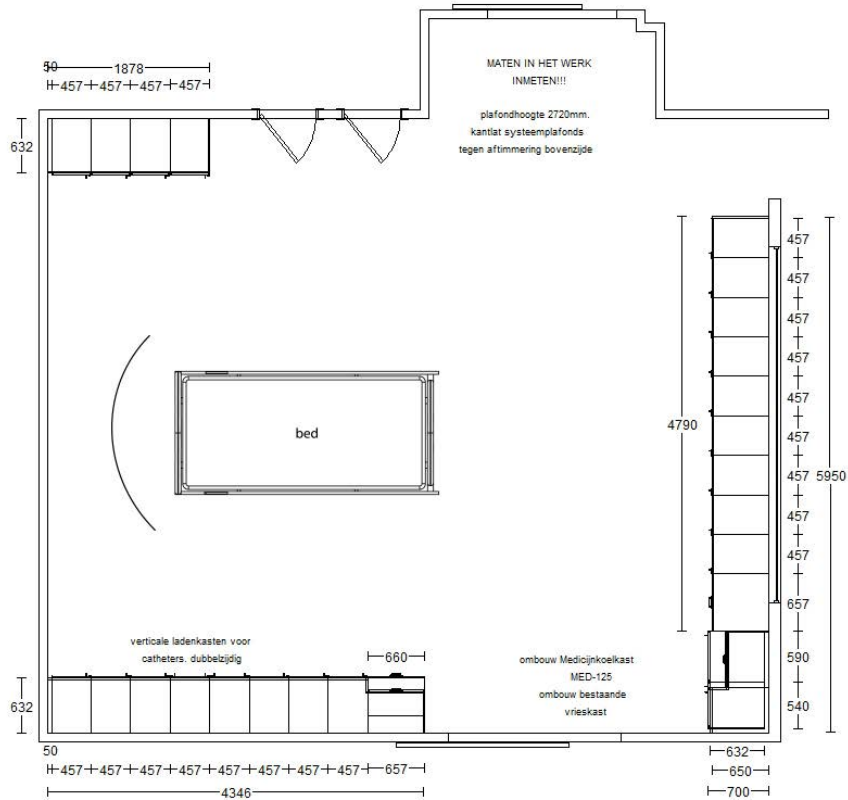

## 3D ILLUSTRATIONS

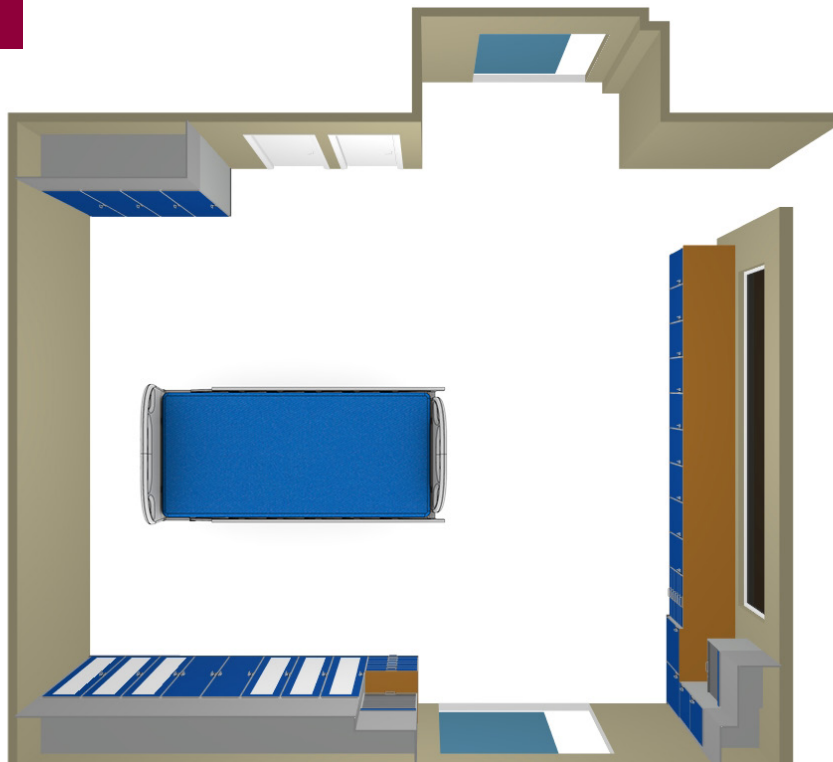

FURNISHED







FURNISHED







FURNISHED





# WORKSPACE UTILIZATION



Gaps or dead air spaces are required between shelves in order to enable access to the products at the back of the shelves

Products on top levels can not be easily accessed

1 SQM/SQF of flat shelving foot print



Dead spaces



Baskets are fully retractable - hence, no gaps are needed between the baskets, no space is wasted and easy access to supplies at the back of the basket is assured

Clear line of sight, easy and ergonomic access to all baskets at the higher levels

Can be decreased into 0.65 SQM/SQF footprint of dense storage

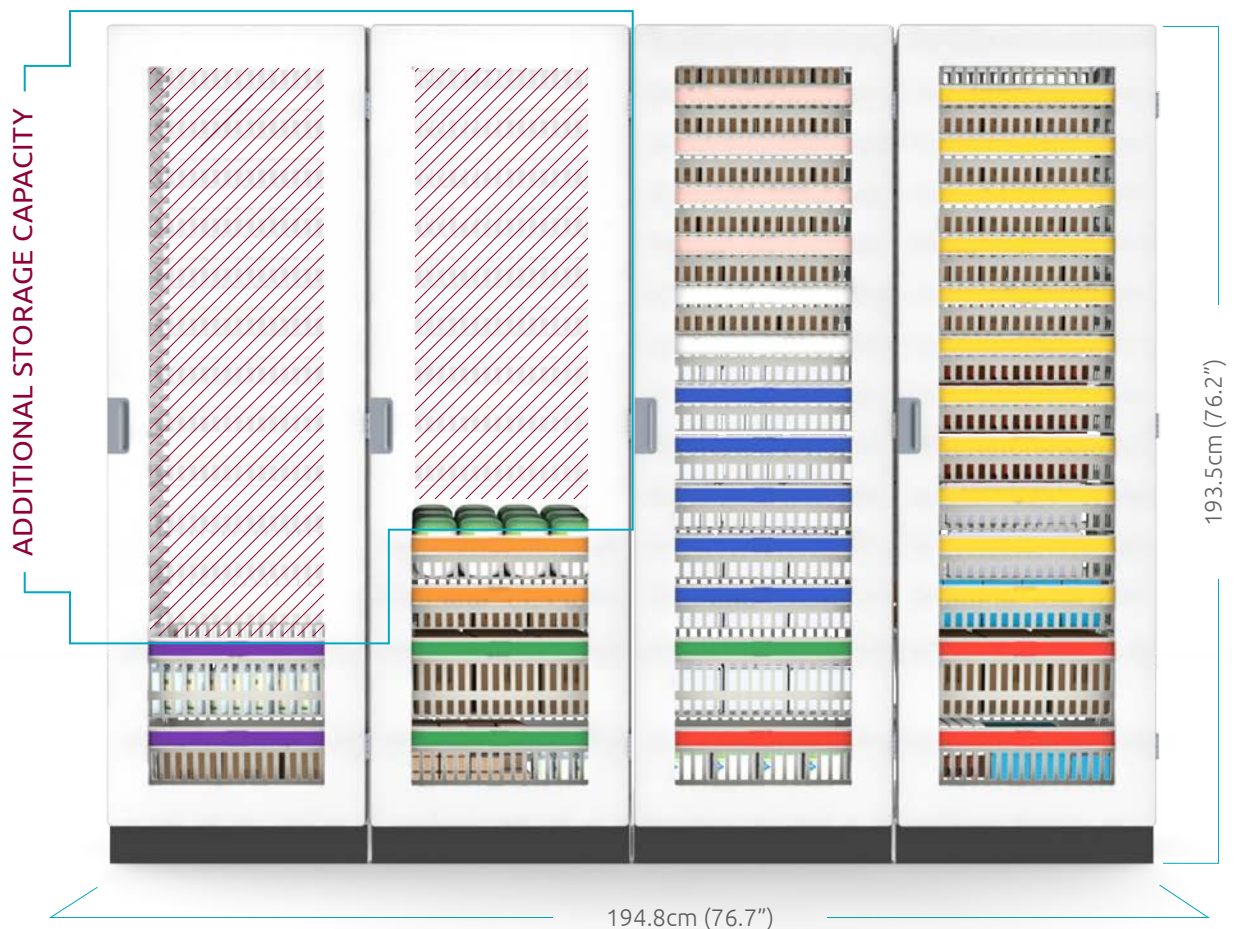

33% to 50% more storage space per sqt/sqm

# UNIQUE FEATURES

## QUIET CLOSURE

All around polymer dust and noise reduction seal



## PULL & TILT

While opening the baskets on the upper levels, the baskets will be tilted 116 degrees, enabling a line of sight and easy removal of products

## RIGID STRUCTURE

Fully glued corpus, 19mm European dense chipboard

## TOE KICK

10 cm of laminated plywood plinth with a set of levelling feet







---

## COLOR CODING

Ergonomic basket handles with interchangeable color strips for color coding purpose

---

## DOOR HINGES

Anodized aluminum hinges

---

## SOLID DOOR

Front solid door with HPL/Formica finish

---

## TELESCOPIC SLIDES

Telescopic slides allowing load of up to 40KG

# TECHNICAL DATA

## MATERIAL

Side walls: 19mm melamine coated chipboard + ABS side panels (interior)  
Plinth: 19mm laminated plywood  
Handle: anodized aluminum  
Edge: 3mm polypropylene  
Glass door: 3mm reinforced glass  
Hinges: 270 degree opening

Tambour door: 16mm polypropylene roller shutter

## CLEANING

Cabinets can be cleaned with a damp cloth. Standard pH-neutral detergents and disinfectants can be used

## COLOR

Sides: polar white  
Door: light grey / silver  
Plinth: dark grey

## LOCKING

Doors can be fitted with a key or code lock



Tambour door



Solid door

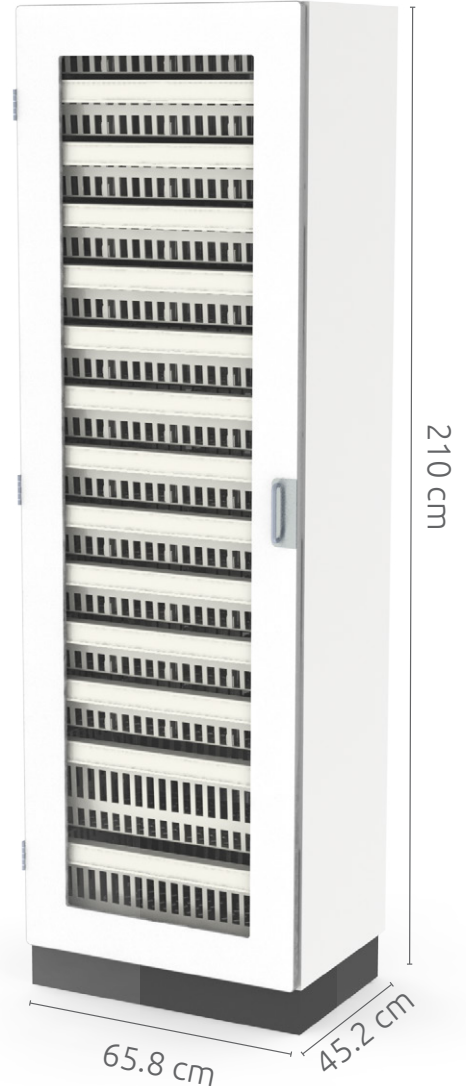

Glass door

**HEAT RESISTANCE**

Max. continuous: 70° C

Max. short term: 90° C

**MAXIMUM LOAD**

20kg per basket

**STANDARD**

HTM71 / ISO standard

\* Depths change according to door type

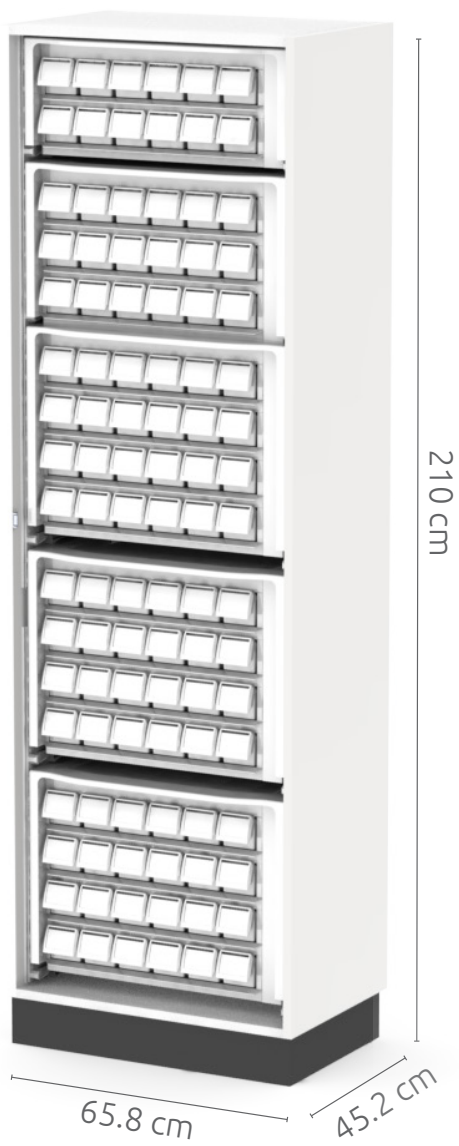

No door



Working area configuration



Tambour door combined with drawer



## SMART AND COST EFFECTIVE DESIGN FOR YOUR WORK SPACE

Design your cabinetry to maximize ease of use, the most often used items will be stored in ball-bearing glides drawers at the heights of 60cm to 110cm (24" to 43"), items that are not often used will be placed in retractable baskets and trays on higher levels and behind doors





# SIDE PANELS FOR MEDICAL CABINETS

With **PEGASUS MEDICAL's** side panels your cabinets will now accommodate ISO trays and baskets

## TILT PANELS

### 9 INSERTIONS

For maximum storage

### FUNCTIONALITY

Tilt functionality while modules are pulled out

### ACCESSORIES

Support wheels for "tilt" side panels (PNWL-SET)



**Tilt Panel U-Type**  
56.5cm deep, 37.5cm high  
PNL(U)-NW (USA: PNL-U-N)



**Tilt Panel E-Type**  
36.5cm deep, 37.5cm high  
PNL(E)-NW (USA: PNL-E-N)

PNWL-SET

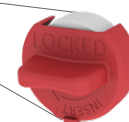

"click-in" wheel



## FLEX PANELS

### 4 INSERTIONS

Horizontal or angle basket insertion

### FUNCTIONALITY

Fixed angled position in high levels, for easy product picking and maximum visibility

### ACCESSORIES

Support wheel for "Flex" side panels (PNLWHEEL)



**"Flex" Panel E-Type**  
40cm deep, 30cm high  
PNL(EU) (USA: PNL-E)



**"Flex" Panel U-Type**  
60cm deep, 30cm high  
PNL(US) (USA: PNL-U)

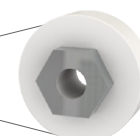

"scraw-in"  
wheel

PNLWHEEL

# ISO ACCESSORIES FOR MEDICAL CABINETS

## TELESCOPIC SLIDES

PEGASUS MEDICAL offers you the possibility of combining telescopic slides made of high-quality steel that can hold up to 40kg \*



BBG-RK-U (60cm)



BBG-RK-E (40cm)

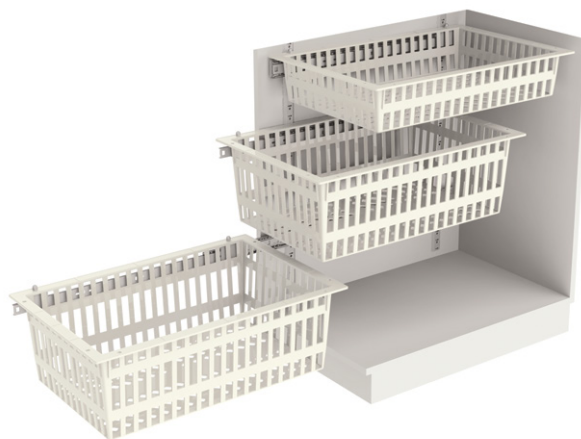

\* For safety reasons it is not allowed to load more than 10 kg in baskets placed on telescopic slides at upper levels (above 140cm)

## DRAWER PULLS

Injected ABS drawer fronts

White 5cm drawer

DWR-PULL-E-W + DWR-FRNT-E-5-W

White 10cm drawer

DWR-PULL-E-W + DWR-FRNT-E-10-W

White 20cm drawer

DWR-PULL-E-W + DWR-FRNT-E-20-W



## BASKET/TRAY HANDLES

Ergonomic grip & color coding



E type handle PC-ABS  
LBL-HDL-E-B

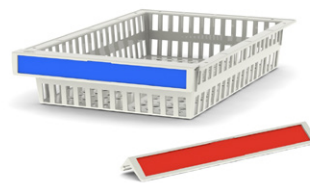

E type handle PC-ABS  
LBL-HDL-U-B

# TRAYS AND BASKETS



## ABS CREAM COLOR



10cm TRAY - T104060ND  
(No Dividers)  
LID - L4060



5cm TRAY - T054060



10cm TRAY - T104060



20cm TRAY - T204060



5cm TRAY - T053040



10cm BASKET - B103040

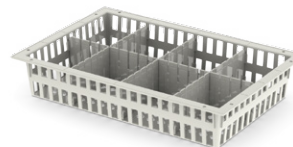

10cm BASKET - B104060



20cm BASKET - B204060

## POLYCARBONATE CLEAR COLOR

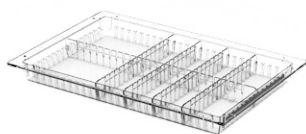

5cm TRAY - T054060PC

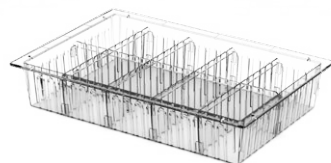

10cm TRAY - T104060PC



20cm TRAY - T204060C



20cm BASKET - B204060PC

## ANTIMICROBIAL MODULES

Proven to reduce the levels of bacteria on the module surface by up to 99% within 24 hours.



5cm TRAY - T054060-AM-G



10cm TRAY - T104060-AM-G



20cm TRAY - T204060-AM-G



LID - L4060-AM-G





## CONTACT US FOR MORE DETAILS

+1 888-276-4750 | [info@pegasusmedical.net](mailto:info@pegasusmedical.net) | [www.pegasusmedical.net](http://www.pegasusmedical.net)

USA / CANADA  
905 E. Rose St Lakeland  
FL 33801 - USA

EUROPE / MIDDLE EAST / ASIA  
Damzigt 13, 3454 PS De Meern  
The Netherlands